

New Working New Living

Website: flexispot.co.uk

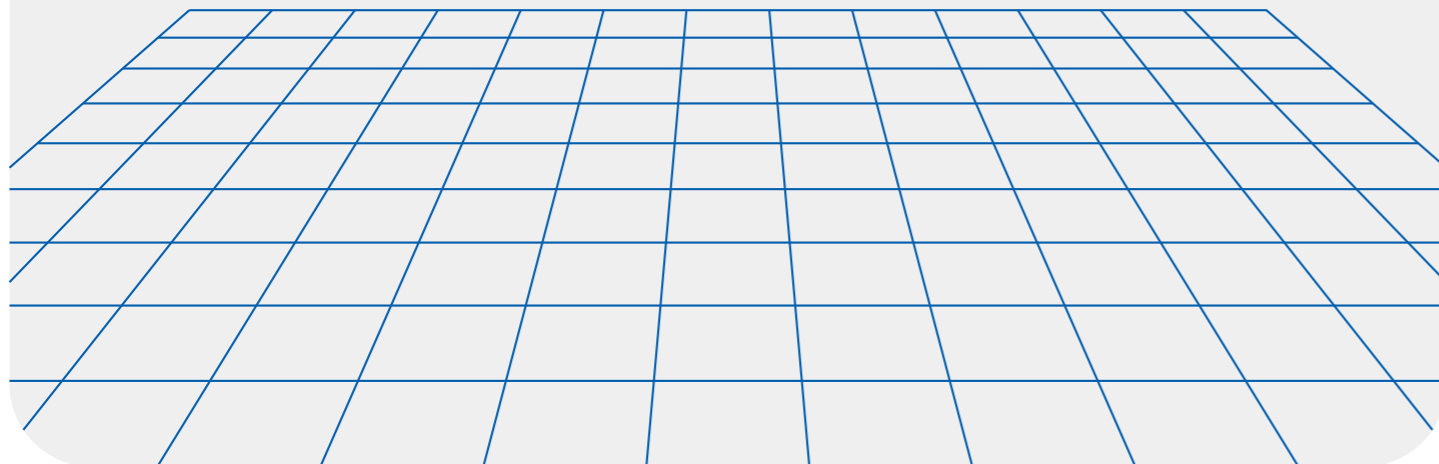
Tel: +44 20 3929 3835 UK

Mail: info@flexispot.co.uk

FLEXISPOT LIMITED, G-PARK UNIT1, MOULTON PARK, SUMMERHOUSE RD, NN3 6WD NORTHAMPTON, UK



Warranty

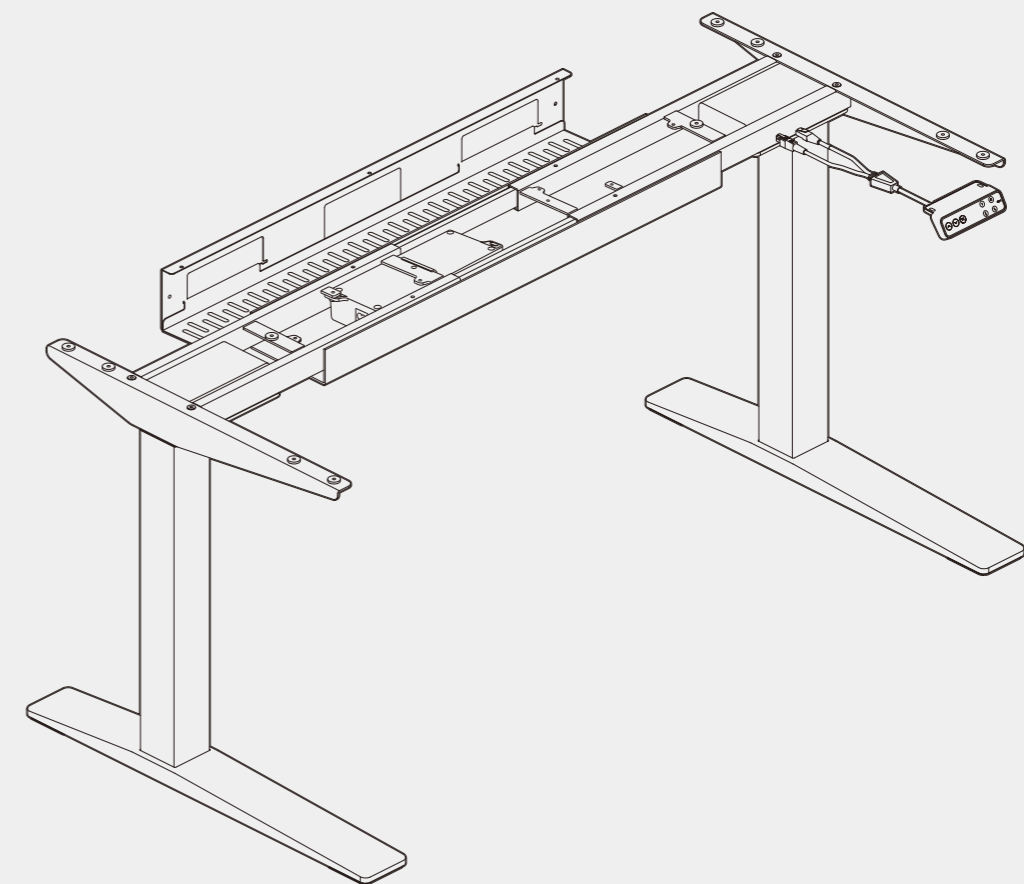


FlexiSpot

User Manual

Standing Desk Frame

Item No. E7-PRO-UKV3



INSTRUCTIONS –
KEEP FOR FUTURE REFERENCE

Usage Precautions: Refer to the accompanying booklet





Specifications

Max. Weight Capacity	180kg
Max. Speed	50mm/s
Adjustable Height	635mm-1285mm
Adjustable Width	1100-1900mm
Applicable Desktop Size	L(1200mm-2000mm)×W(600mm-800mm)×H(≥18mm)

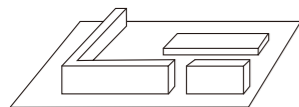
The product has been designed to meet Commission Regulation with regard to ecodesign requirements for electric power consumption of low power consumption mode condition of electrical and electronic household equipment.

The technical information of low power consumption mode condition:

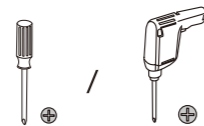
Mode	Power consumption (Watts)	The period (Minutes)
Low power consumption mode condition	0.2 W	1min

The website URL of the English version electronic instruction manual:
<https://flexispot.co.uk/next-generation-standing-desk-e7-pro>

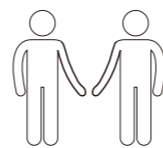
Pre-installation Guide



Assemble on a foam to prevent scratch

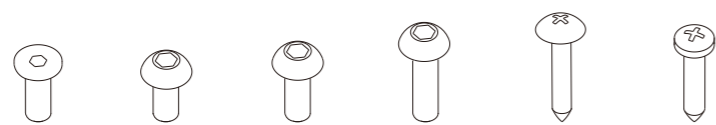


Phillips screwdriver or drill required (not provided)



Get a friend for help

Accessory Package

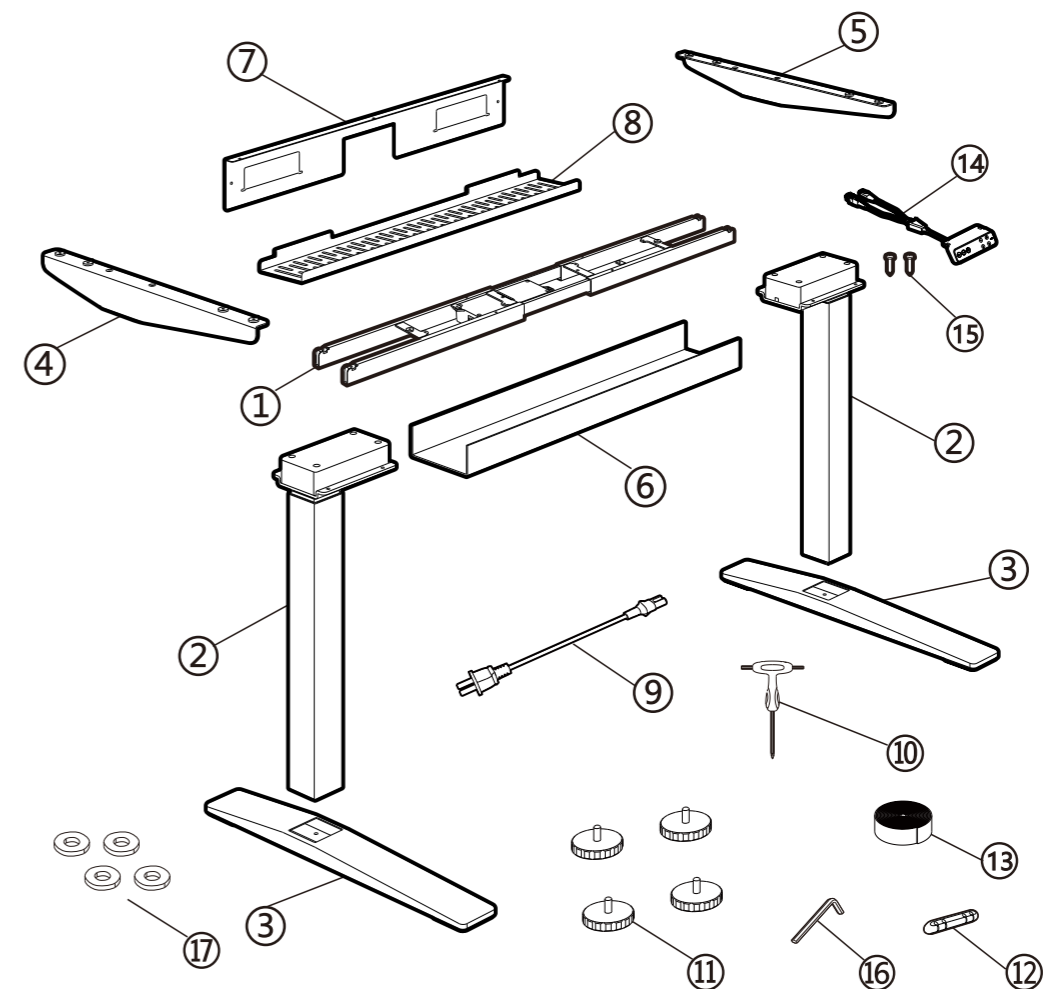


Ax4 Bx4 Cx8 Dx8 Ex11 Fx3

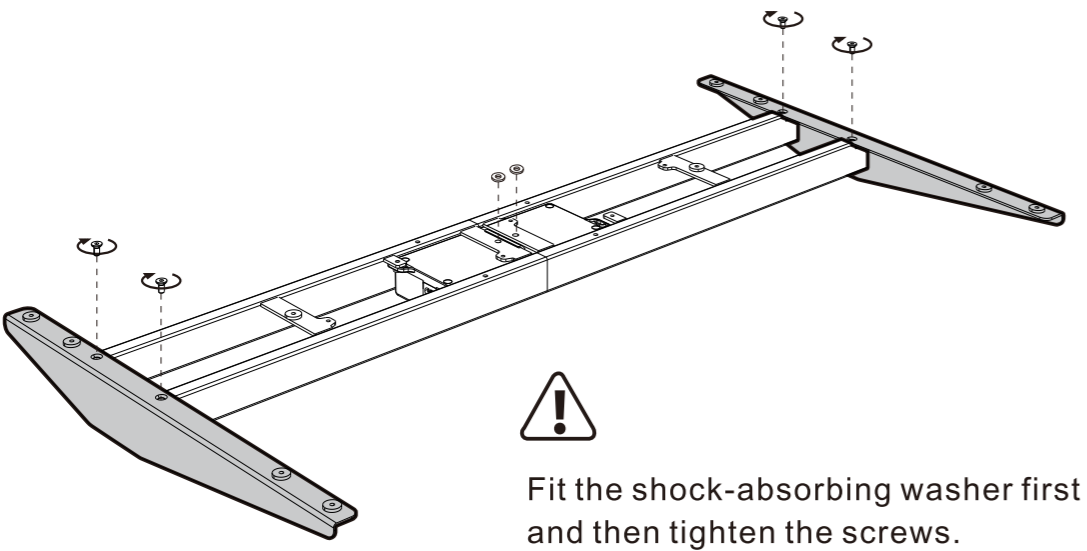
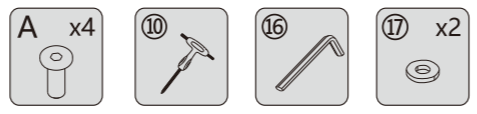


Diagram of Components

No.	Part	No.	Part
①	Supporting beam x1	⑨	Power plug x1
②	Lifting column x2	⑩	T-wrench x1
③	Feet x2	⑪	Feet pad x4
④	Left side bracket x1	⑫	Cable manager x1
⑤	Right side bracket x1	⑬	Velcro x1
⑥	Cable tray x1	⑭	Keypad x1
⑦	Cable holder x1	⑮	Keypad screw x2
⑧	Cable tray x1	⑯	4x4 wrench x1
		⑰	Shock-absorbing washer x4

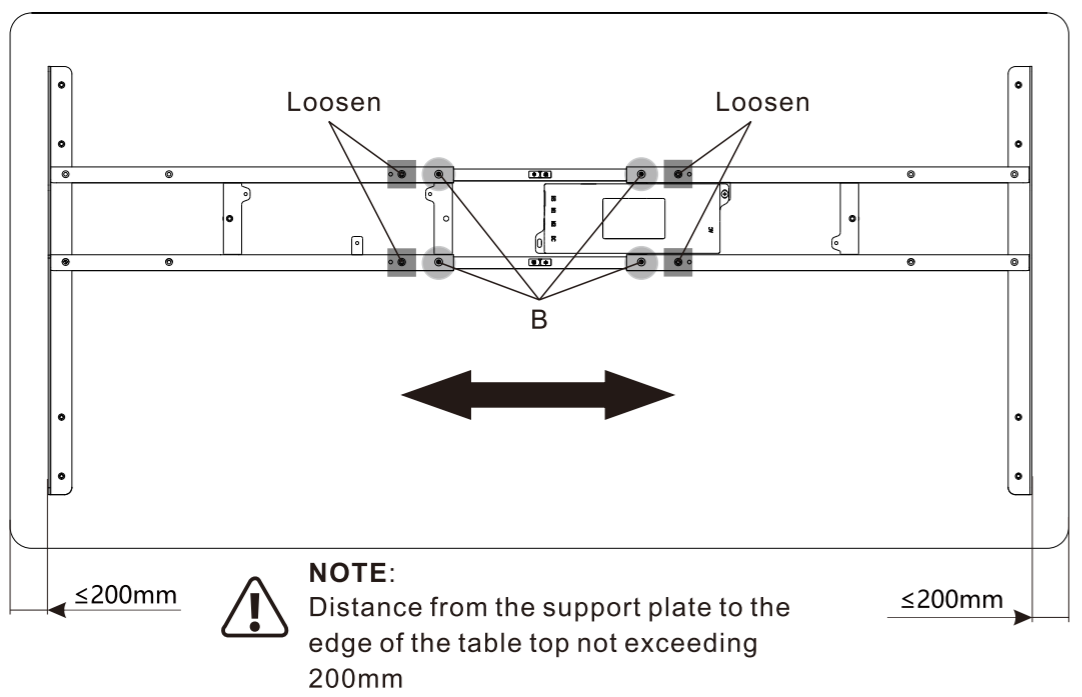


1 Attach the side brackets to the beam

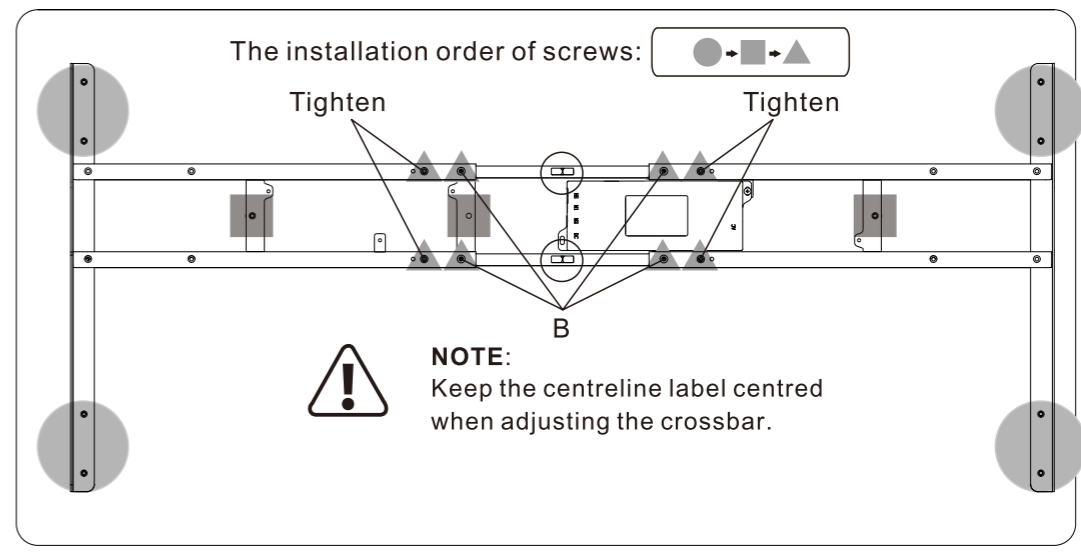


2 Adjust the length of the frame

- a) Install screw B shown ● but do not fully tighten them.
- b) Loosen the four screws shown ■ and adjust the length of the crossbar.

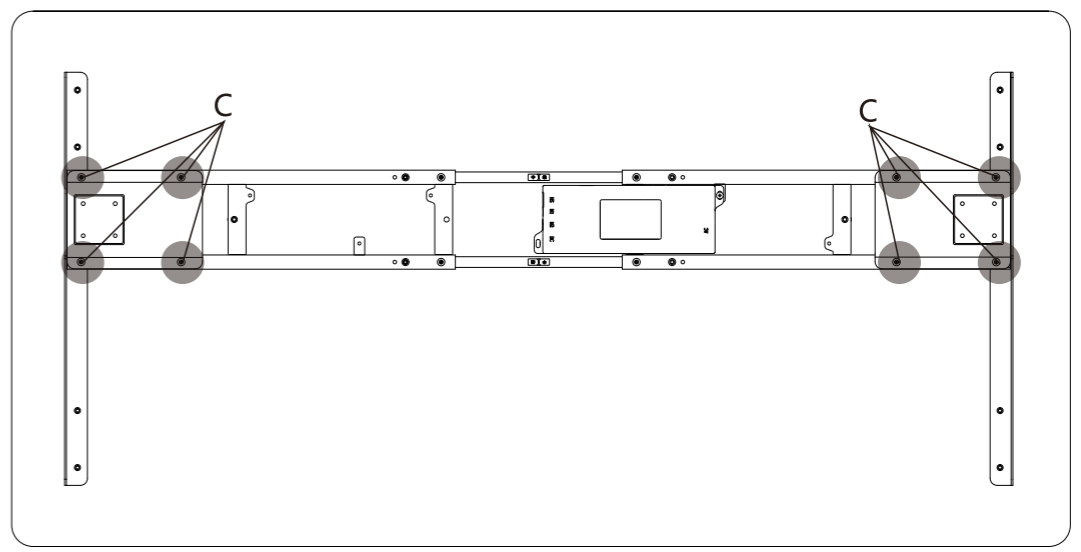


3 Affix the tabletop



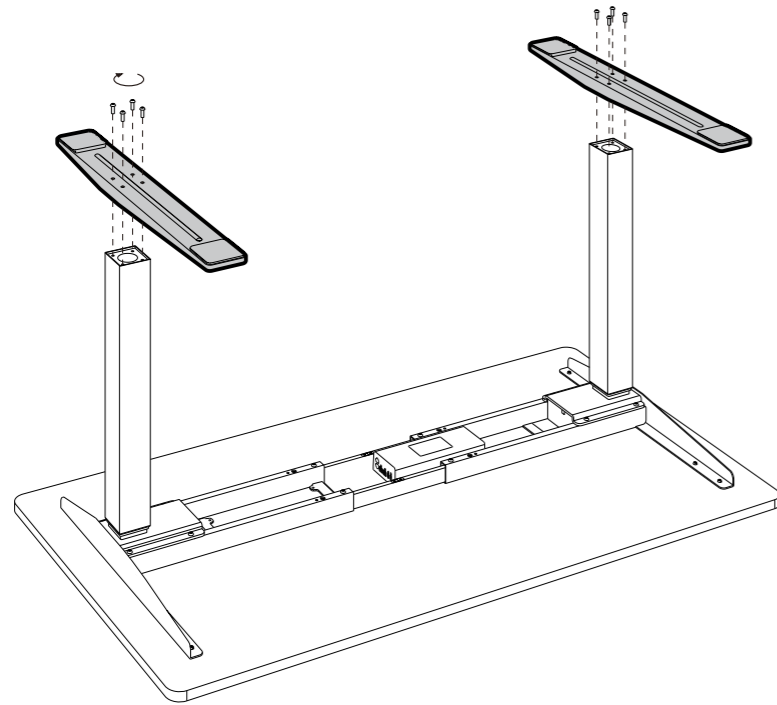
NOTE: When the beam is stretched to the widest point, 11 screws need to be installed to fix the table, and 1 spare screw. Otherwise, only 10 screws need to be installed to fix the table, and 2 spare screws.

4 Install the leg columns

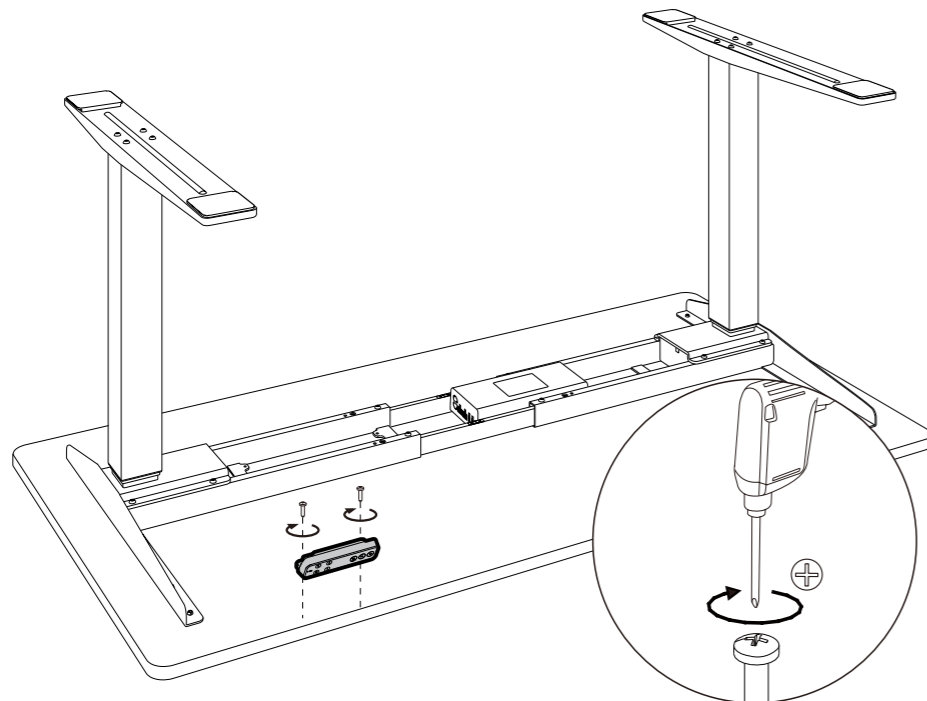
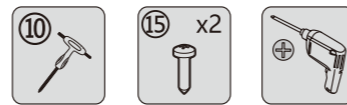


5 Attach the feet

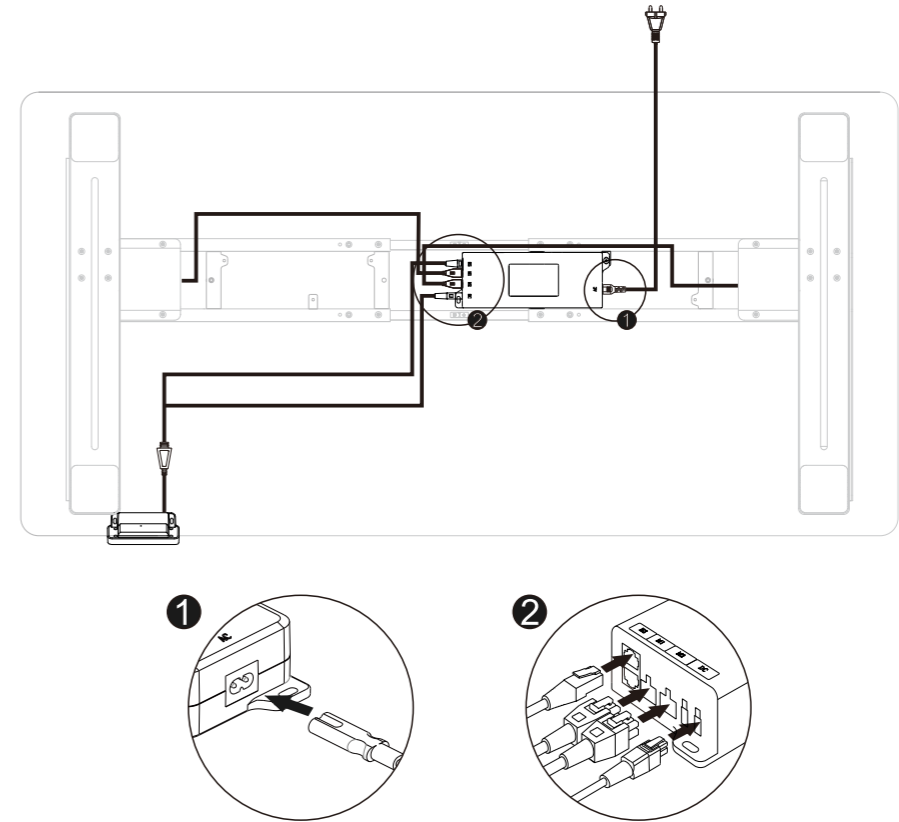
NOTE:
Please note the orientation of the table legs when installing.



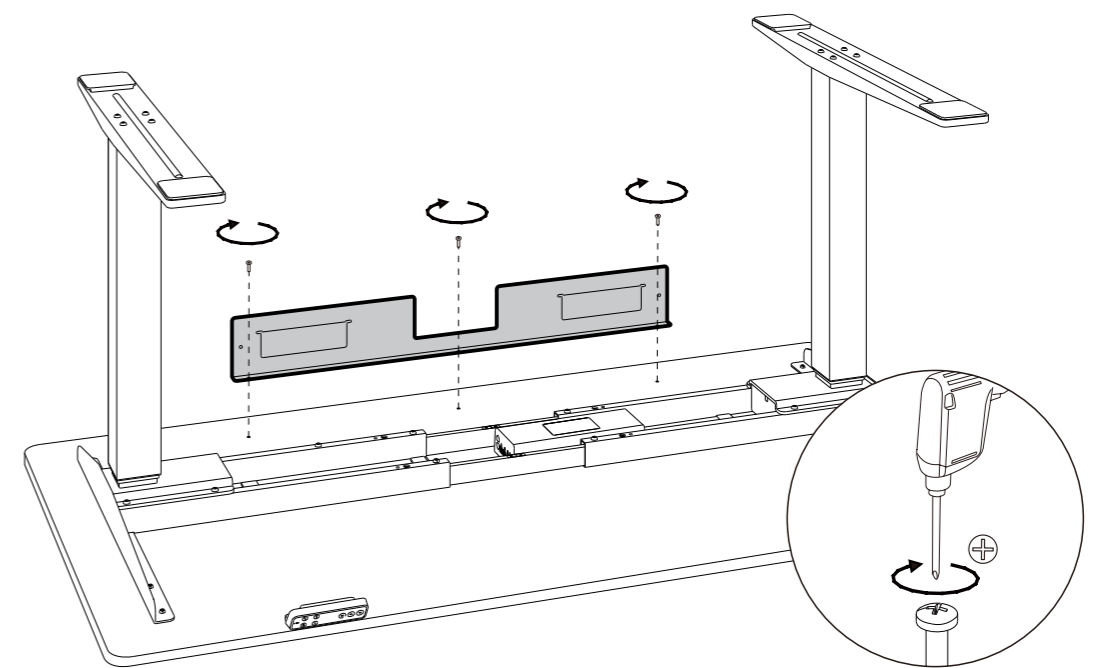
6 Fix the keypad



7 Connect the wires

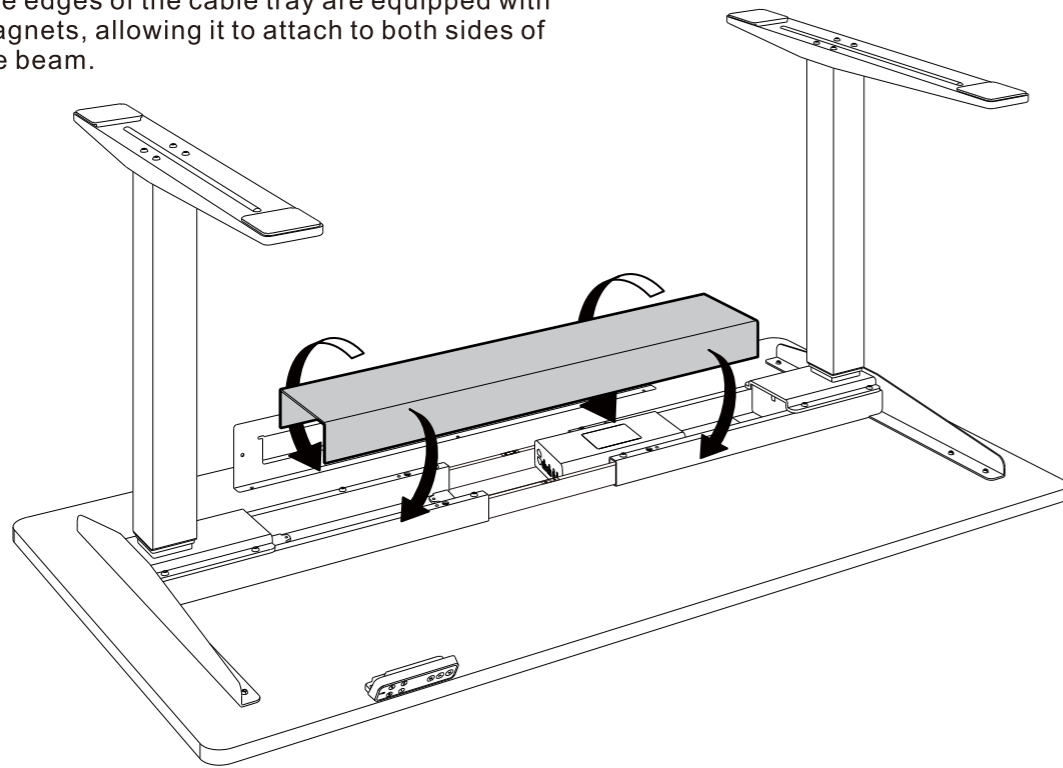


8 Attach the cable tray

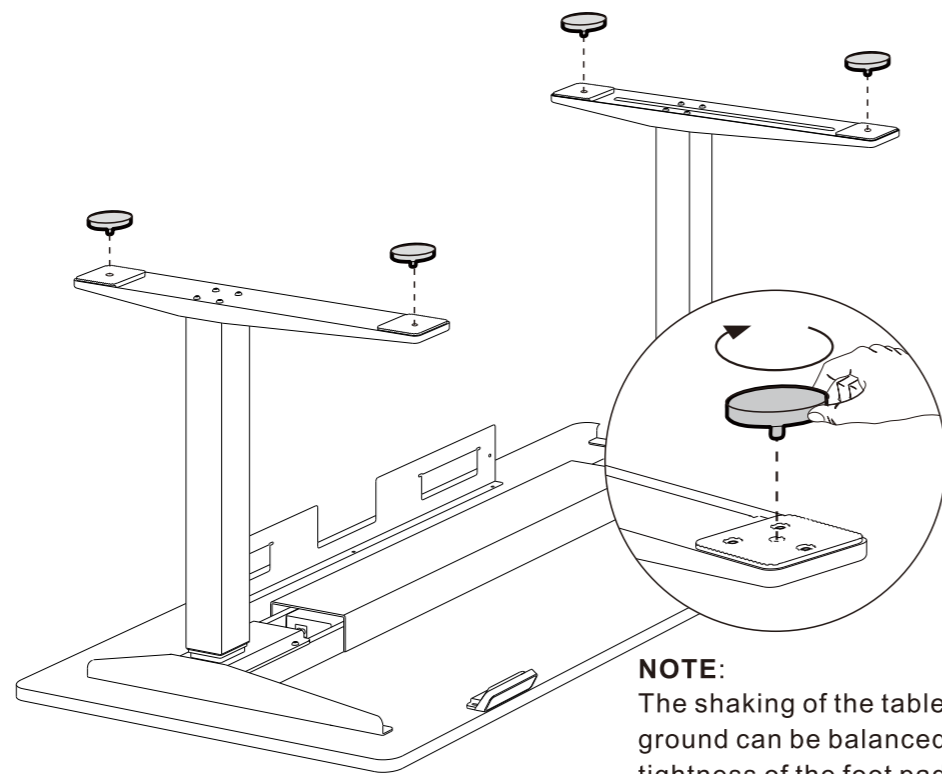


9 Attach the cable tray

NOTE:
The edges of the cable tray are equipped with magnets, allowing it to attach to both sides of the beam.

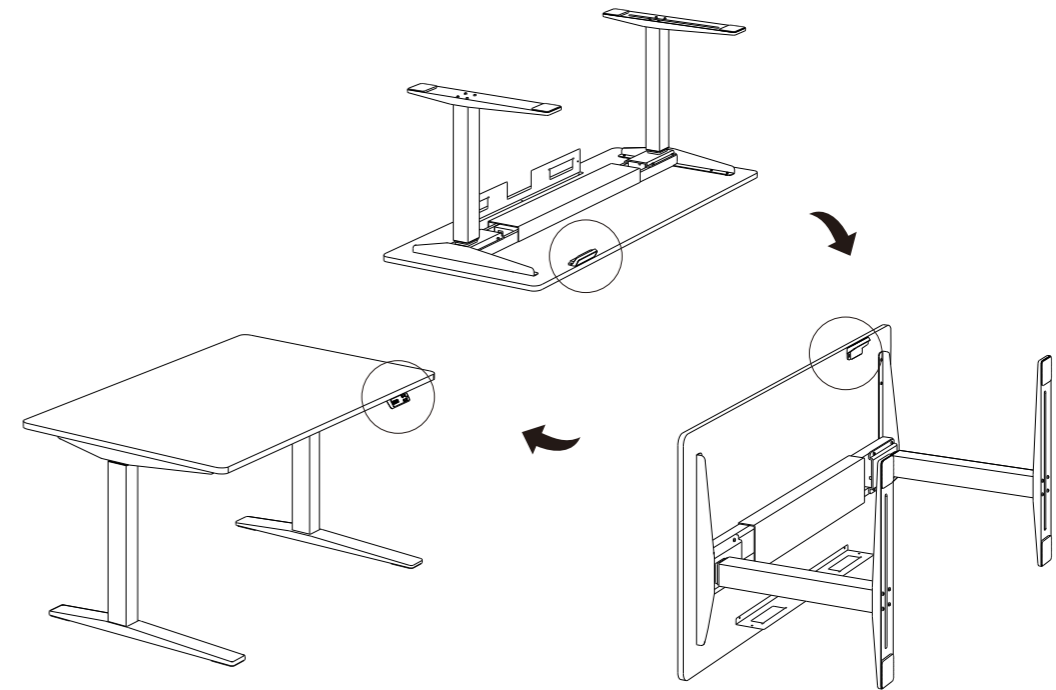


10 Adjust foot pads for balance

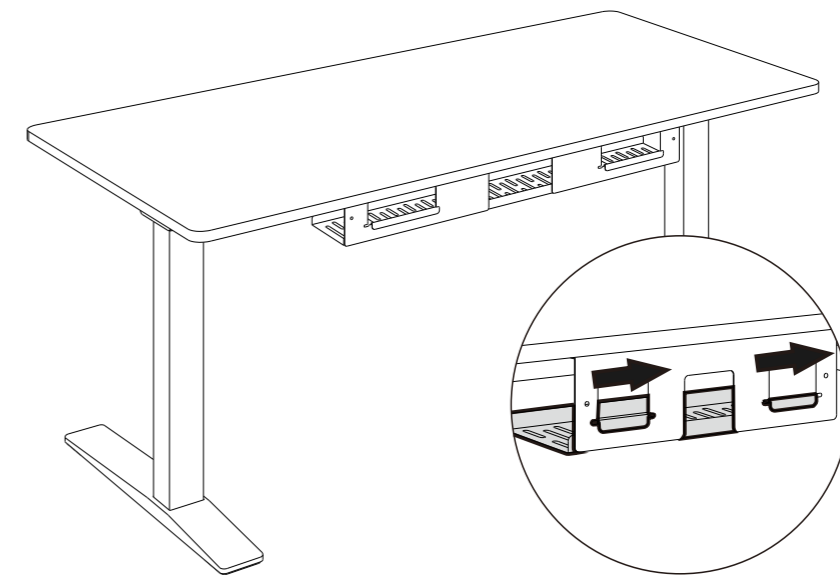


NOTE:
The shaking of the table due to the uneven ground can be balanced by adjusting the tightness of the foot pads. This step is installed according to the situation.

11 Finished



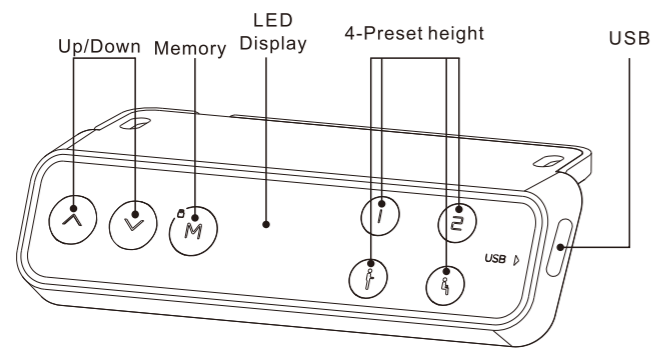
12



NOTE:
The cable ties has a total length of 2m and is a reusable product. You can cut it to the desired length to secure cables as needed.



13 Keypad User Guide

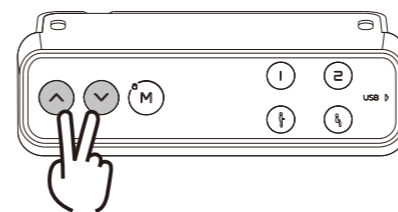


Attention

Please ensure that there are no obstructions to the table and that all wires are long enough to move the table up and down.

Advice

Preset your comfort level to "1" when sitting and "2" when standing, plus other preset heights can be freely set to other heights.



Collision prevention sensitivity adjustment:

a. Press and hold the "▲" and "▼" button for 5 seconds at the same time to switch the sensitivity.

There are four levels of sensitivity:

"A-0", Switching off the anti-collision function.

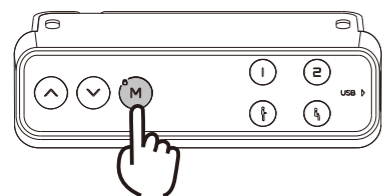
"A-1", low sensitivity.

"A-2", Medium sensitivity.

"A-3", high sensitivity

b. During height adjustment, when desktop comes in contact with another object, it instantly stops and reverses to avoid damage.

c. Press and hold the "▲" and "▼" button for 5 seconds at the same time. If the display does not display the above code, there is no anti-collision function.



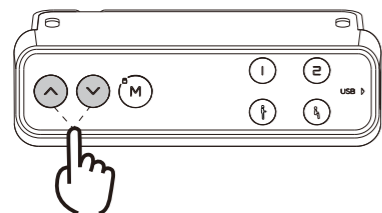
Child lock function

a. When the child lock is turned on, the blue indicator light of the child lock will be on ("▼" and "M" above)

b. Press the button and the indicator light flashes once.

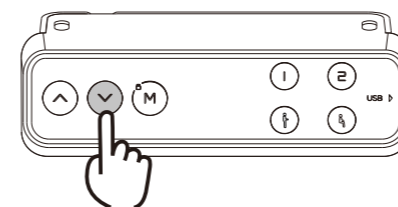
c. To release or open the child lock, you need to press and hold the "M" button for about 5 seconds;

d. Disengage the child lock function, all buttons can work normally.



Height Adjustable Function:

Height Adjustable Function: Press the "▲" or "▼" button to adjust the height. The LED display shows the current height.



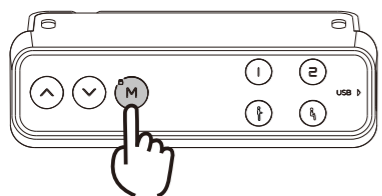
Troubleshooting:

a. Definition of reset function: The display shows "R5f" or "r5t", press and hold down the down key "▼" until the table is lowered to the lowest position and rebound to stop, the display shows the lowest height, release the 'V' down key, the reset is finished and the table can be used normally.

b. When it doesn't work and the LED shows "E01" or "E02", please retry 18mins later.

c. If other codes appear, press "▼" no response, please make sure the connection cable is not broken and connected properly, and power off for more than 10 seconds, reconnect the power and press "▼", the display to show "R5f" or "r5t" and long press "▼" down key to reset.

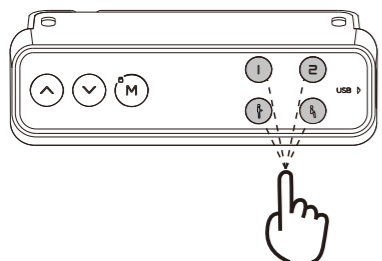
d. If all these above process are in efficient, please contact our customer service.



Height Memory Function:

a. Press the "▲" or "▼" button and adjust the height to the desired height. Press "M" to save the height, and the screen will display "5-" Press "1" or "2" or "↓" or "↵" that is, save the height to the corresponding, "1" or "2" or "↓" or "↵" position, which will show in the display screen as "5-1" or "5-2" or "5-3" or "5-4"

b. Press "1" or "2" or "↓" or "↵" button directly to automatically adjust the memory height you saved.



14 Resolving Common Issues

The following tips will help you identify and correct common issues. If you encounter an issue not listed in the table below, or if you follow the instructions below and the issue is still not resolved, please contact your supplier. All such anomalies or errors can only be investigated and corrected by the manufacturer or specially trained personnel.

Issue	Solution
Electronic functions are not working properly	Verify cables are connected correctly
Slow ascent	Check whether the desk load is too heavy (over 180 kg)
Desktop slips during ascent	
Keypad often goes into reset state	
Only lowers but does not raise / Only raises but does not lower	Reset the desk
Desk does not rise or lower the full distance	
Desk remains at lowest height	
Exceeds duty cycle requirements (Duty cycle: Max 2 min ON / 18 min OFF)	Let the desk idle for 18 minutes with the power connected
Press the down button and the device does not drop but rises	Check for obstructions under the table or if the harness is hanging down

15 Recycling and Disposal

This product cannot be disposed of as household waste. To prevent damage to the environment, this product should be recycled. Please use the relevant recycling systems available to you or contract the distributor or manufacturer for recycling assistance.

Manufacturer: Loctek Ergonomic Technology Corp.
 Add.: 588 Qihang South Road, Binhai Industrial Zone, Yinzhou District, Ningbo, Zhejiang, 315145, China
 +86 574-88070203
 Importer: FLEXISPOT LIMITED
 Add.: G-PARK UNIT1, MOULTON PARK, SUMMERHOUSE RD, NN3 6WD NORTHAMPTON, UK
 +44 20 3929 3835
 info@flexispot.co.uk